

Sai Maruthi Nagar Gudalavalli Lay out Plan

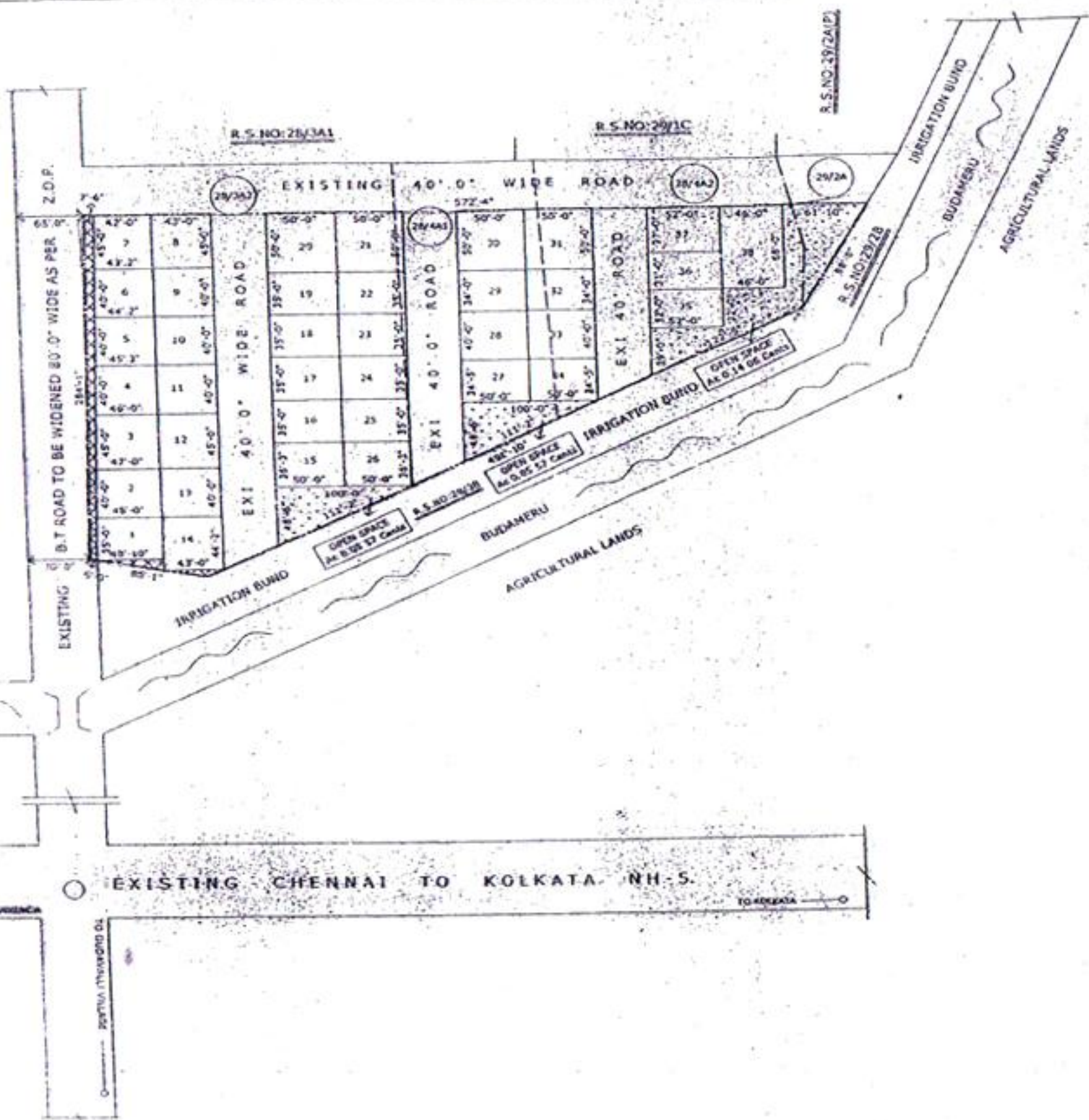

L.P.NO : 35/2007/VJA
 FILE NO : RC - C2 : 396/2007.
 (MORTGAGE RELEASED)

LAY-OUT PLAN IN R.S.NO'S : 28/3A2(P), 4A1(P), 4A2(P); 29/2A(P); IN GUDAVALLI VILLAGE OF VIJAYAWADA RURAL MANDAL, KRISHNA DISTRICT.

REFERENCE

- BOUNDARY OF THE LAY-OUT :
- BOUNDARY OF THE SURVEY NUMBER :
- BOUNDARY OF THE SUB-DIVISON :
- AREA OF THE LAY-OUT : Ac 2.52 Cents
- % OF OPEN SPACE (10%) : Ac 0.25 20 Cents
- EXISTING ROADS :
- NUMBER OF PLOTS : 38
- RAIN WATER HARVESTING STRUCTURE : R.W.H.S
2.00 X 1.50 X 1.50 Metres
- ROAD AFFECTED PORTION :

NOTE: MORTGAGE RELEASED FOR PLOTNO'S:15(TO)20, 26, 34, 35, 38; RELEASED WIDE RECONVEYANCE DEED NO:1594/2008; DATED:12-05-2008.

V.G.T.M URBAN DEVELOPMENT AUTHORITY,VJA.



[Signature]
 SH. V.S.PRASAD
 VICE CHAIRMAN

CHIEF PLANNING OFFICER

[Signature]
 PLANNING OFFICER

[Signature]
 ASSISTANT PLANNING OFFICER

SCALE
 1" : 66' 0"

[Signature]
 JUNIOR PLANNING OFFICER

[Signature]
 SURVEYOR